

To connect custom materials to Revit first copy all the necessary materials to a folder that you decided to use, then copy the path to that folder.

Open Revit file

Press **File** then **Options**

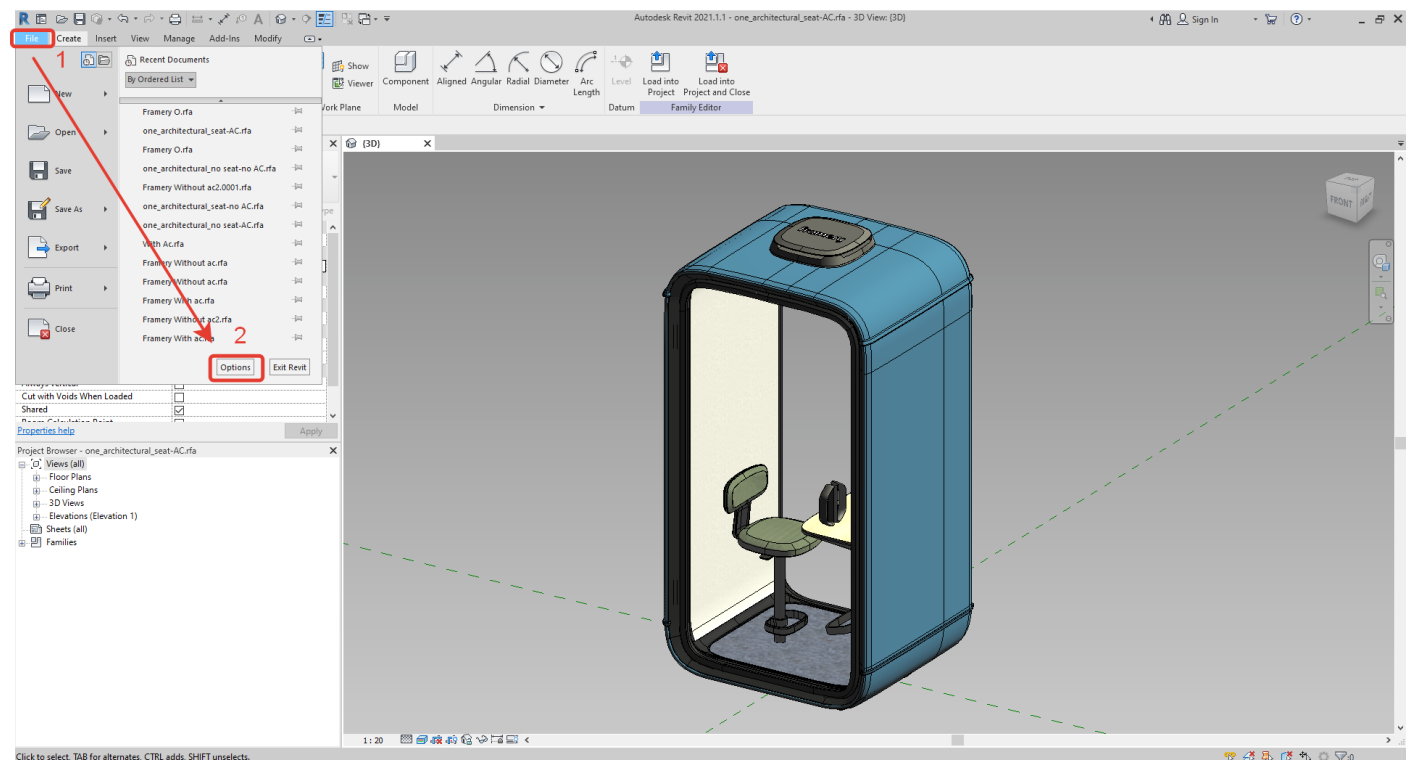

In the Options window select **Rendering**, then press “+” (Plus) button, paste the folder location into the created line, then press “OK”

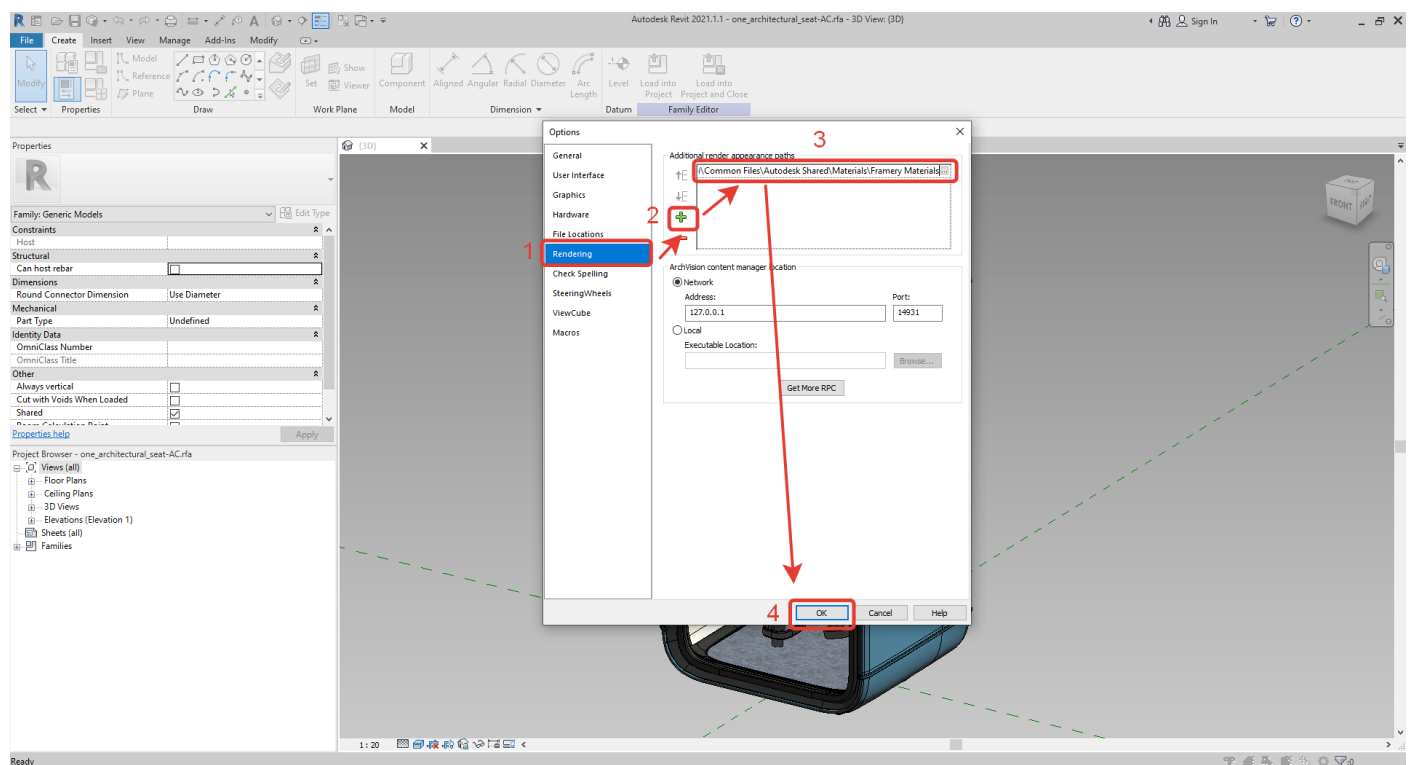

Save the file

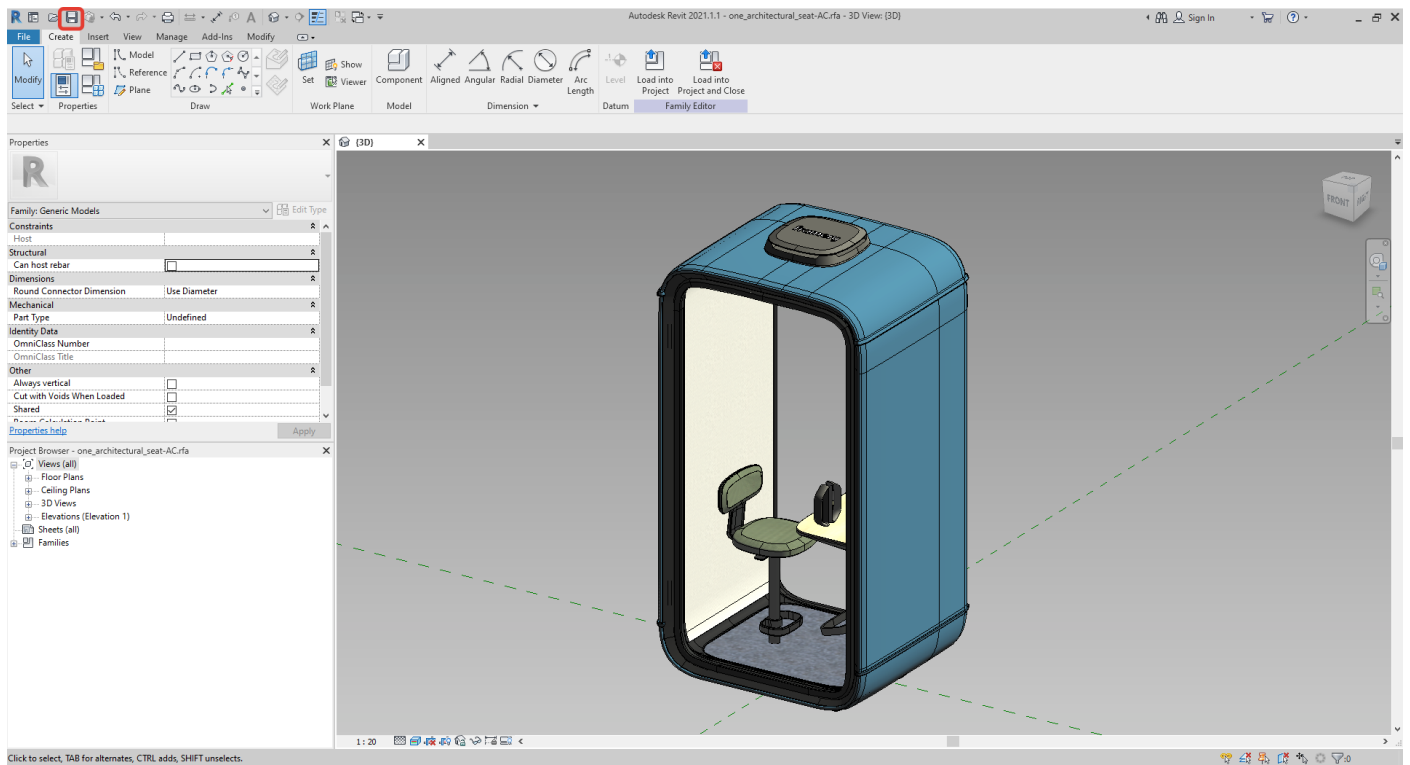

To change materials select **Create** menu and press **Family Types** button

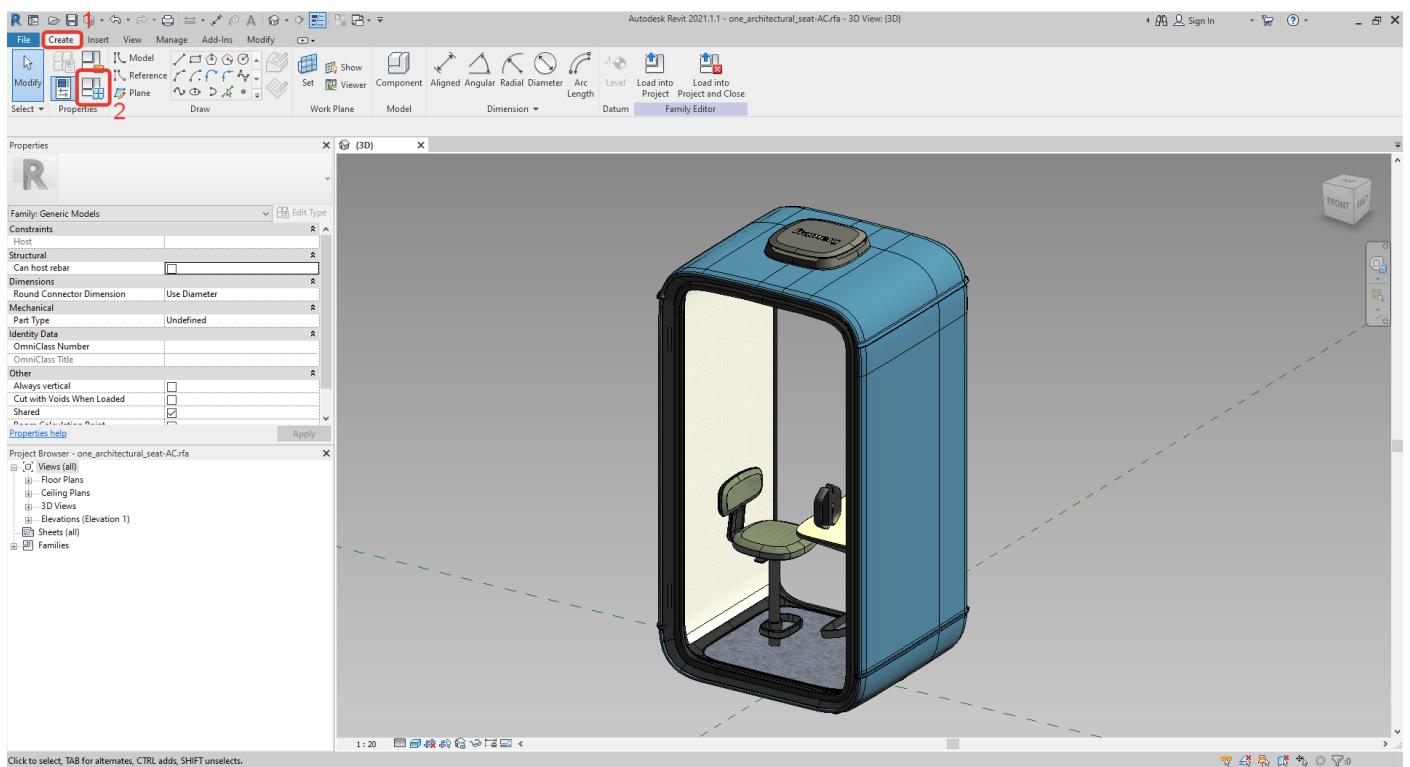

In the **Family Types** window press the cell next to the POD part you want to change, then press the arrow next to the cell and select desired material, once you have changed the materials in all the necessary lines press **Apply** then **OK**

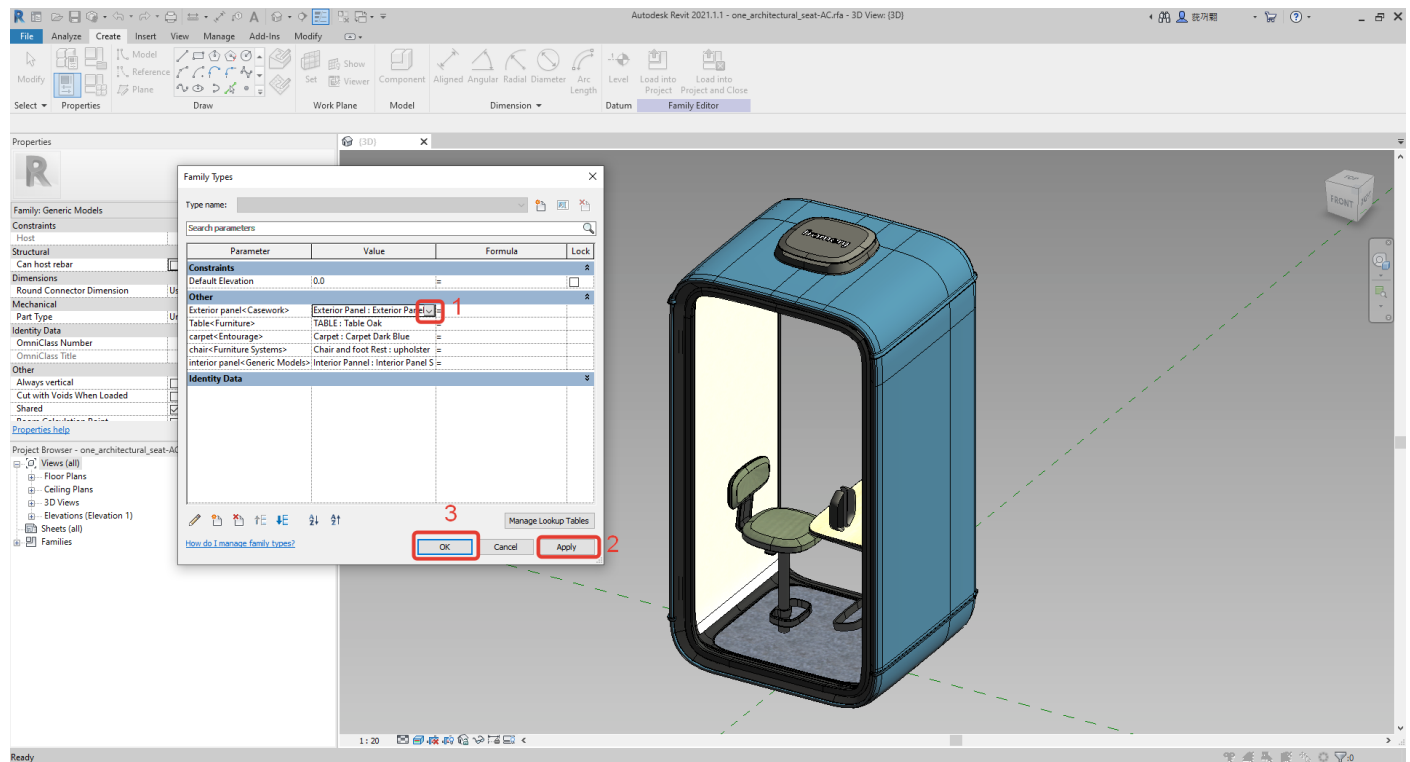

The materials have been changed

